

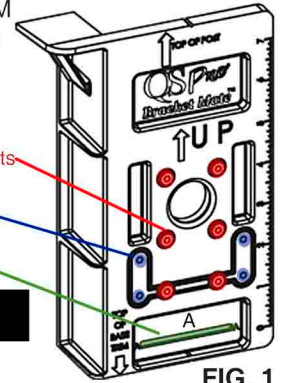

# Bracket Mate™



## Tools Required



Marking Pencil



Drill & 1/8" bit

Screw holes for Standard and T-Rail Brackets

Screw holes for Contoured Brackets

Pencil line window "A" for 45 or 22.5 Bracket Adaptors.

## Top and Bottom QS Pro Bracket Mounting Instructions

### Level Applications Using 32" or 38" Balusters Only.

**IMPORTANT:** Before beginning your installation, cut post sleeves 40" long for a 36" high rail and 46" long for a 42" high rail. Slide Part # QCAP4PRO QS Pro Low Bases onto posts.

#### Mounting Bottom Brackets

Place the QS Pro Bracket Mate™ flush with the base trim. Pre-drill 6 **inside** holes. SEE FIG. 1 Attach bottom mounting brackets to post with (6) #10 screws (provided)

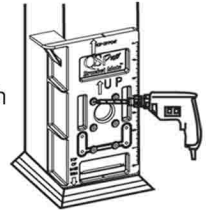

#### Mounting Top Brackets

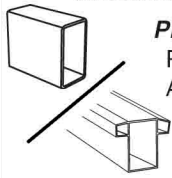

##### PRO V or PRO Z Standard or T-Rail Top Rail

Place the QS Pro Bracket Mate™ flush with the top of post. Pre-drill 6 **inside** holes. SEE FIG. 1 Attach top mounting brackets to post with (6) #10 screws (provided).



##### PRO V Contoured Top Rail

Place the QS Pro Bracket Mate™ flush with the top of post. Pre-drill 4 **outside** holes. SEE FIG. 1 Attach top mounting brackets to post with (6) #10 screws (provided)

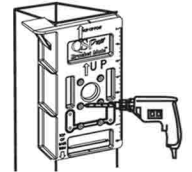

## For 22.5 Degree Standard, 45 Degree Standard or 45 Degree Contoured Bracket Adaptor Attachment

#### Mounting Bottom Brackets

Place the QS Pro Bracket Mate™ flush with the base trim. Mark a pencil line in window "A". SEE FIG. 1 Place bottom edge of bracket adaptor on the line. Using the 4 **inside** holes on the adaptor pre-drill mounting bracket holes. Place bracket mounting plate on top of bracket adaptor and attach to post using (4) #10 screws (provided)

#### Mounting Top Brackets

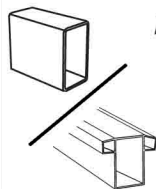

##### PRO V or PRO Z Standard or T-Rail Top Rail

Measure 30 3/4" for 36" high rail or 36 3/4" for 42" high rail from top of base trim and mark a pencil line on post. Place bottom edge of bracket adaptor on the line. Using the 4 **inside** holes on the adaptor pre-drill bracket mounting holes. Place bracket mounting plate on top of bracket adaptor and attach to post using (4) #10 screws (provided)



##### PRO V Contoured Top Rail

Measure 32" for 36" high rail or 38" for 42" high rail from top of base trim and mark a pencil line on post. Place bottom edge of bracket adaptor on the line. Using the 4 holes on the adaptor pre-drill bracketing mounting holes. Place bracket mounting plate on top of bracket adaptor and attach to post using (4) #10 screws (provided)

Any questions call the QS Pro team at 1-877-649-9896

HOW TO USE